

<https://www.fortuneandcoates.co.uk>



**FORTUNE & COATES**

The People's Estate Agent



FORTUNE & COATES



## 3 Aspen Way, Harlow, CM17 0FJ

**£150,000**

SHARED OWNERSHIP 50%. Fortune and Coates are delighted to offer to the market this beautifully presented two-bedroom, ground floor apartment situated in the sought-after location of Aspen Way, Gilden Park, Harlow.

Upon entering, you are welcomed by a spacious entrance hallway which provides access to all rooms, along with useful storage, creating a practical and well-laid-out living space.

The heart of the home is the impressive open-plan kitchen/living area, offering a bright and airy space ideal for both relaxing and entertaining. The kitchen is fitted with a range of modern wall and base units, providing ample cupboard and worktop space, along with integrated oven, hob and dishwasher with space for a fridge/freezer,

**Kitchen/living room 17'6" x 17'2" (5.34 x 5.25)**

**Bedroom 16'2" x 8'9" (4.93 x 2.67)**

**Bedroom 9'0" x 15'10" (2.75 x 4.84)**

AGENT NOTE: The information provided about this property does not constitute or form part of an offer or contract, nor may it be regarded as representations. All interested parties must verify accuracy and your solicitor must verify tenure/lease information, fixtures & fittings and, where the property has been extended/converted, planning/building regulation consents. All dimensions are approximate and quoted for guidance only as are floor plans which are not to scale, and their accuracy cannot be confirmed. Reference to appliances and/or services does not imply that they are necessarily in working order or fit for the purpose.

## Floor Plan

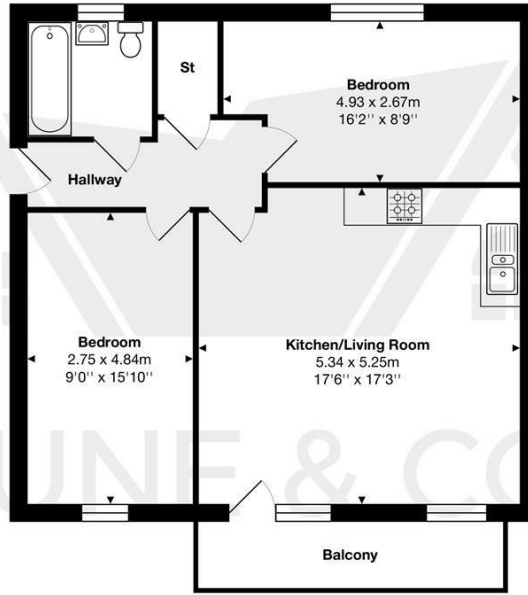

Total Area: approx. 65.6 m<sup>2</sup> ... 706 ft<sup>2</sup> (excluding balcony)

THE FLOORPLAN IS FOR ILLUSTRATIVE PURPOSES ONLY AND IS NOT TO SCALE.  
Measurements and features are approximate and may differ from the actual property. Verify all details independently; no liability is accepted for errors or omissions.

Property marketing provided by [www.fotomarketing.co.uk](http://www.fotomarketing.co.uk)

## Area Map

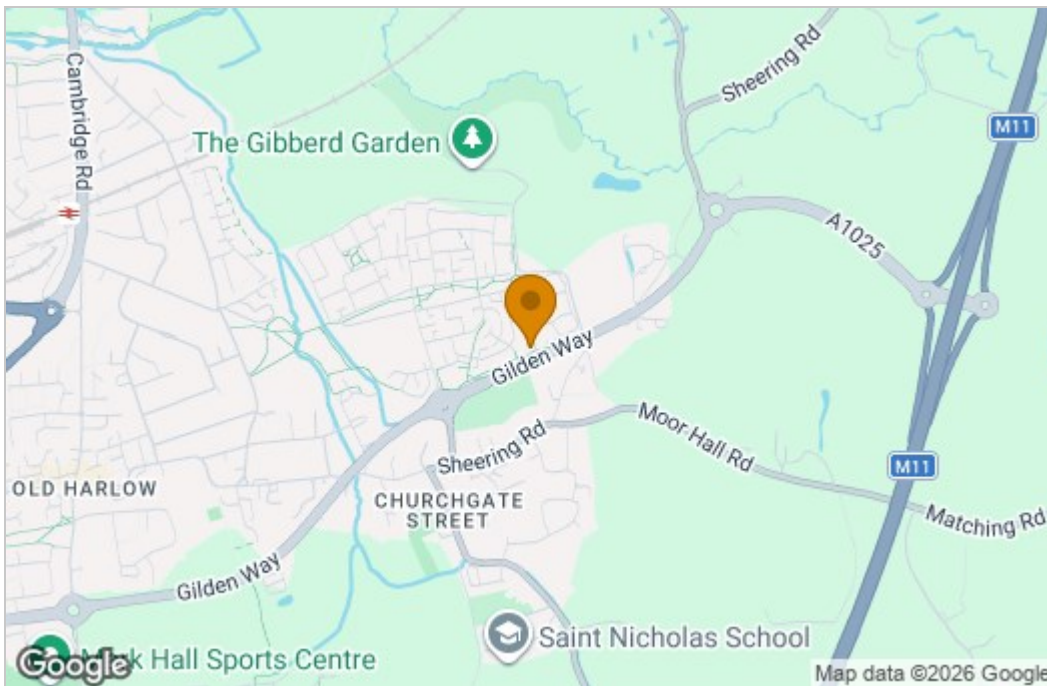

## Energy Efficiency Graph

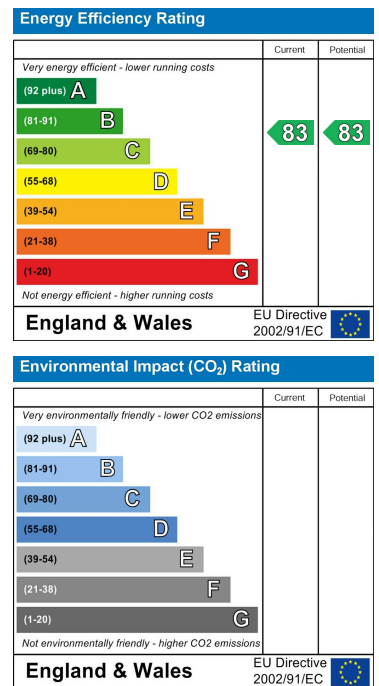

These particulars, whilst believed to be accurate are set out as a general outline only for guidance and do not constitute any part of an offer or contract. Intending purchasers should not rely on them as statements of representation of fact, but must satisfy themselves by inspection or otherwise as to their accuracy. No person in this firm's employment has the authority to make or give any representation or warranty in respect of the property.